



## FEATURES

- 30° deflected flat jet
- High impact force



## APPLICATIONS

- Washing lines
- Paint plants

# OL30 Series

*Deflected flat jet nozzles*

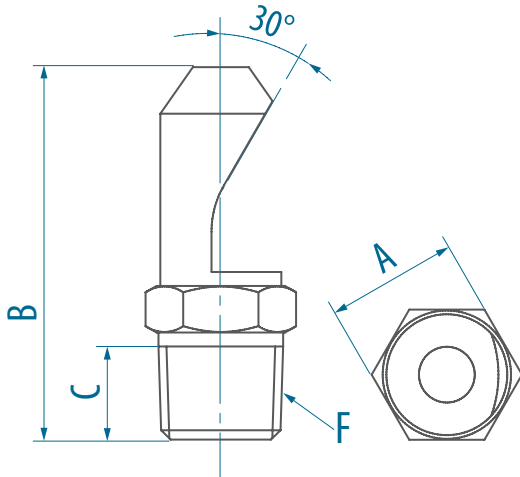

Dim.	Thread Code
	Y32
F	1/4"
A	14
B	40
C	10

## OPERATIVE DATA

ANGLE	Material			Thr.	FLOW CODE	Operating curve							
	04	06	08	Y32		Flow-rate discharged [l/min] at pressure [bar(g)]							
	AISI 303	Brass	PVC	1/4" BSPT		0,5	0,7	1	1,5	2	3	5	7
90°	x	x	x	x	<b>383</b>	1,00	1,18	1,41	1,73	<b>2,00</b>	2,45	3,16	3,74
	x	x	x	x	<b>394</b>	1,25	1,48	1,77	2,17	<b>2,50</b>	3,06	3,95	4,68
	x	x	x	x	<b>406</b>	1,60	1,89	2,26	2,77	<b>3,20</b>	3,92	5,06	5,99
	x	x	x	x	<b>418</b>	2,00	2,37	2,83	3,46	<b>4,00</b>	4,90	6,32	7,48
	x	x	x	x	<b>429</b>	2,50	2,96	3,54	4,33	<b>5,00</b>	6,12	7,91	9,35
	x	x	x	x	<b>441</b>	3,15	3,73	4,45	5,46	<b>6,30</b>	7,72	10,0	11,8
	x	x	x	x	<b>453</b>	4,00	4,73	5,66	6,93	<b>8,00</b>	9,80	12,6	15,0
	x	x	x	x	<b>464</b>	5,00	5,92	7,07	8,66	<b>10,0</b>	12,2	15,8	18,7
	x	x	x	x	<b>475</b>	6,25	7,40	8,84	10,8	<b>12,5</b>	15,3	19,8	23,4
	x	x	x	x	<b>488</b>	8,0	9,5	11,3	13,9	<b>16,0</b>	19,6	25,3	29,9