



## FEATURES

- Adjustable spray direction up to 30°
- Integrated quick-clamp
- Memo-replacing



## APPLICATIONS

- Pre-treatment tunnels
- Phosphating plants

# OVSW-IR Series

*Ball joint vee-jet nozzles*

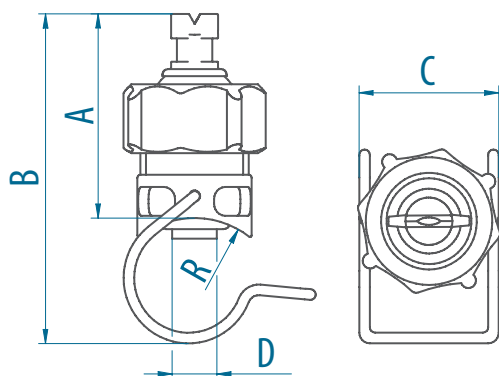

	Thread Code			
Dim.	W06	W07	W08	W09
NPS	1"	1 1/4"	1 1/2"	2"
R	17	22	25	30
A	65	65	65	65
B	100	110	120	130
C	50	50	50	50
D	13	15 (21)	15	15



## OPERATIVE DATA

ANGLE	Mat.	Thread				FLOW CODE	Operating curve						
	33	W06	W07	W08	W09		Flow-rate discharged [l/min] at pressure [bar(g)]						
	PP/GF	NPS 1"	NPS 1 1/4"	NPS 1 1/2"	NPS 2"		0,5	0,7	1	1,5	2	3	5
60°	x	x	x	x	x	429	Grey	2,50	2,96	3,54	4,33	5,00	6,12 7,91
	x	x	x	x	x	441	Lilac	3,15	3,73	4,45	5,46	6,30	7,72 10,0
	x	x	x	x	x	453	Brown	4,00	4,73	5,66	6,93	8,00	9,80 12,6
	x	x	x	x	x	464	Yellow	5,00	5,92	7,07	8,66	10,0	12,2 15,8
	x	x	x	x	x	475	Red	6,25	7,40	8,84	10,8	12,5	15,3 19,8
	x	x	x	x	x	488	Green	8,00	9,47	11,3	13,9	16,0	19,6 25,3
	x	x	x	x	x	499	Blue	10,0	11,8	14,1	17,3	20,0	24,5 31,6